

THE JOURNAL RECORD

Friday, April 4, 2014

www.journalrecord.com

Vol. 119, No. 67 • Two Sections



CANADIAN VALLEY TECHNOLOGY CENTER

Eye on storm safety



The new administrative building will also house the practical nursing program. COURTESY RENDERINGS

BY MOLLY M. FLEMING
THE JOURNAL RECORD

EL RENO – On May 31, the Canadian Valley Technology Center sustained an estimated \$30 million in damage when a tornado swept through the area. A wind turbine used in training had been bolted to the ground, but was picked up by the tornado and thrown into the administrative building that housed the day care center.

The center's classes are now at the former Holt Ford dealership and the day care is housed at a church, both in Yukon.

While the classes and day care are comfortable in their temporary locations, CVTC is ready to move forward and bring its students back to its campus at 6505 Oklahoma 66. The center has hired Gary Armbruster with Oklahoma City-based MA+ Architecture to design its new campus. The main building is still in the final designing stages, and will include the day care, separate from a new administrative building. Both buildings will have a new, modern aesthetic, making them an attractive site on Route 66.

The old administrative building has been removed, leaving the concrete slab steel columns that served as the basis for Armbruster's design. The new building will be 21,000 square feet, sitting north of the main center. The exterior entrance to the administrative building will be prominent, making it clear to visitors where they are to enter.

The main entryway will have a welcome desk where students or visitors can learn how to get around the building. The finishes will include carpet, natural stone tile, and other natural elements. Armbruster said lots of windows were incorporated into the design to allow for natural light.

Inside, students and staff members will find a building that is an upgrade from the previous one constructed more than 40 years ago. Most of the building will be used for administrative staff, with

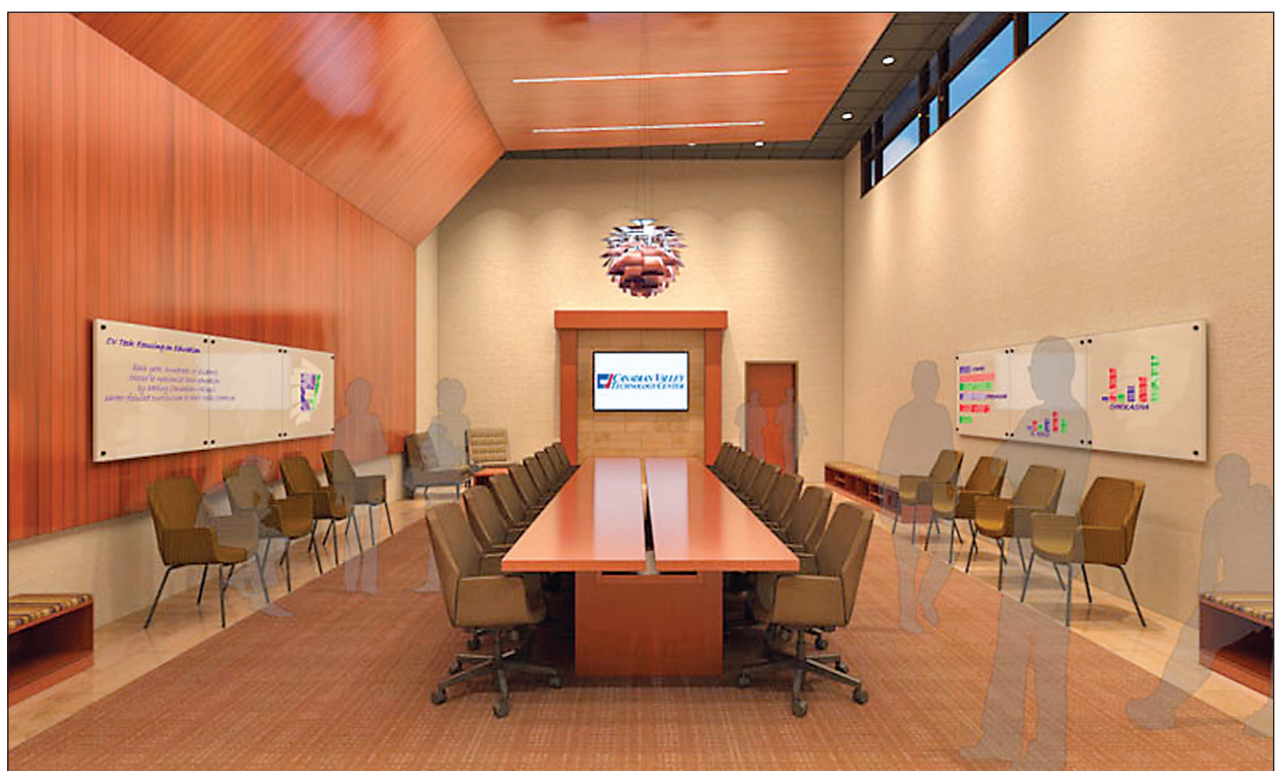

The boardroom will have wooden panels and high ceilings.

the rest devoted to the practical nursing program. Armbruster said the students in the nursing program attend class at night, so it made sense for their classrooms to be in the smaller building. This will allow them to have a centralized location, creating a safer environment.

Safety is one of the top concerns with the new buildings. There will be five storm shelters throughout the entire campus, with one in the administrative building. The shelter is equipped to hold the entire capacity of the building. The building will also have 20 offices, a large boardroom, three classrooms with labs, and a computer lab.

The boardroom will have wooden panels and high ceilings. Armbruster said the previous building had a small boardroom, so the new one will offer plenty of space for the board and any other attendants. It will feature a conference table that can be split into two tables as needed. The wood panels and high ceilings are meant to create a warm atmosphere in the space.

"I told their district administrator, 'If you have a board meeting and you fill this up, it's probably not a very good meeting,'" Armbruster said jokingly.

The administrative building is expected to be complete by summer 2016.